

Touch Solid 16

ACWG

AQUALEX

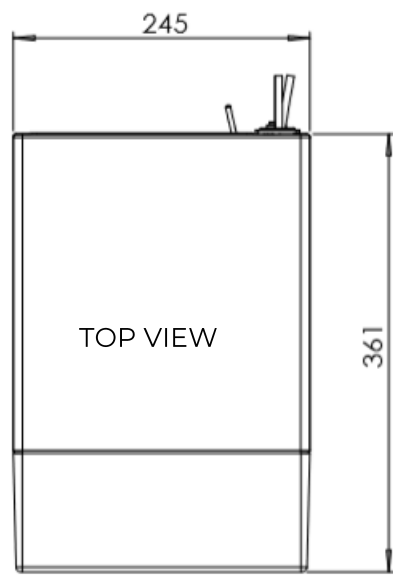
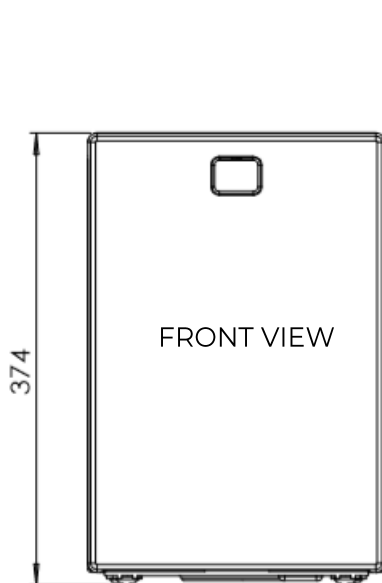
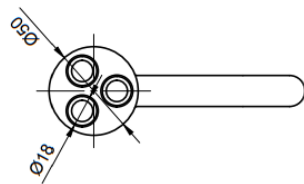
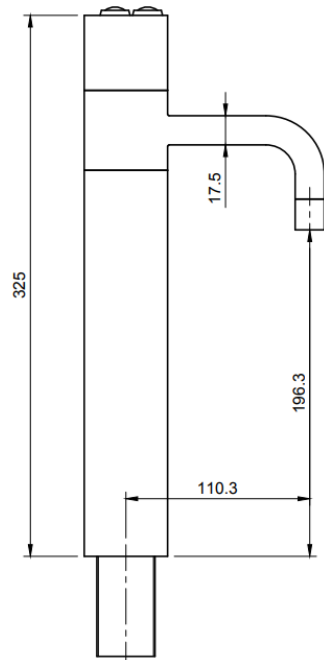
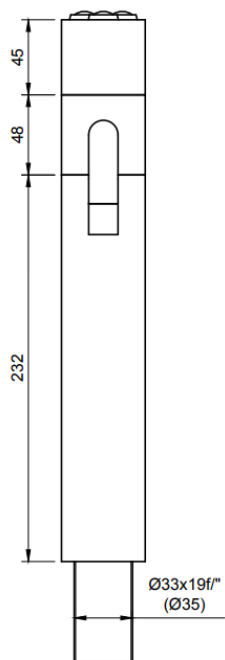

Touch Solid 16

ACWG

AQUALEX

CAPACITEITEN

CAPACITIES

	Per uur Per hour	In continu Continuously
Touch Solid 16 ACWG	16L	4L*

Inkomend water 14°C

Incoming water 14°C

***Uitkomend gefilterd water varieert tussen 3-10°C**

**Outcoming filtered water varies between 3-10°C*

AFMETINGEN

DIMENSIONS

	l	b	h
Toestel / Device	361	245	374
Min. binnenmaten kast*	370	265	500
<i>Min. inside dimensions cupboard*</i>			
Aqualex kraan / Aqualex tap	187	50	325

***Voorzien voor verluchting, koolzuurgasfles en filter**

**Provide for ventilation, carbon dioxide bottle and filter*

TECHNISCHE INFORMATIE

TECHNICAL INFORMATION

Werkdruk water MIN-MAX	2.5 - 4bar
<i>Pressure water MIN-MAX</i>	
Koelgas hoeveelheid	R134A 0,040 kg
<i>Refrigerant gas quantity</i>	
Max. vermogen	225W
<i>Max. power</i>	
Lekbak	Optioneel (extra fiche)
<i>Drip tray</i>	<i>Optional (external sheet)</i>
Wall	Optioneel
	<i>Optional</i>

TECHNISCHE VOORZIENINGEN

TECHNICAL PROVISIONS

Stopcontacten	2 x 230V
<i>Sockets</i>	
Noodzakelijke watertoevoer	3/4" dubbele dienstkraan met terugslagklep
<i>Necessary water supply</i>	<i>Double service tap with back valve</i>
Te boren gaten	
<i>Drill holes</i>	
Kraan	Ø35
<i>Tap</i>	
Gelieve genoeg vrije ruimte te voorzien onder de gaten om de Aqualex kraan/onderdelen vlot te kunnen aansluiten.	
Please provide enough free space under the drilled holes to ensure that the Aqualex tap/components can be connected easily.	
Ventilatie	Bovenaan en onderaan min. opening van 200cm ² (koelkast principe).
<i>Ventilation</i>	Top and bottom min. Opening of 200cm ² (refrigerator principle).